

TOP VIEW

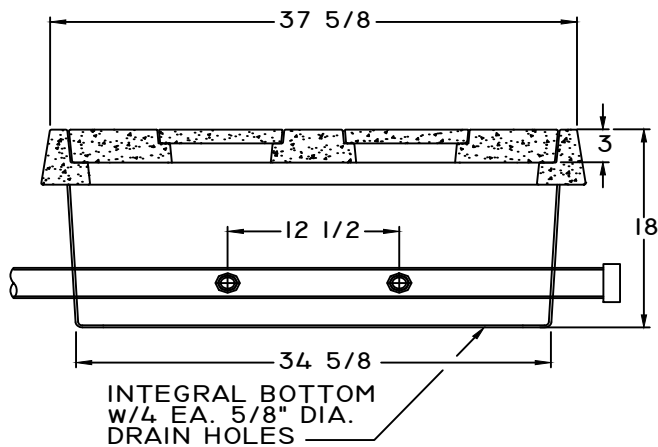

SECTION

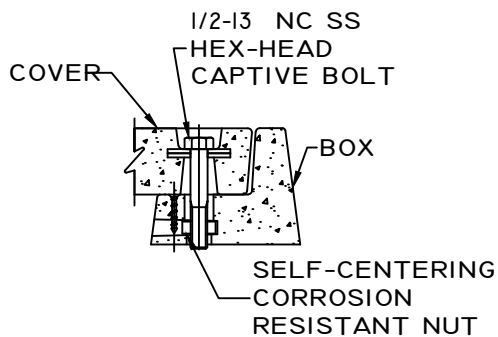

COVER BOLTDOWN DETAIL

- MATERIAL: FIBERGLASS REINFORCED POLYMER CONCRETE & FIBERGLASS REINFORCED POLYMER

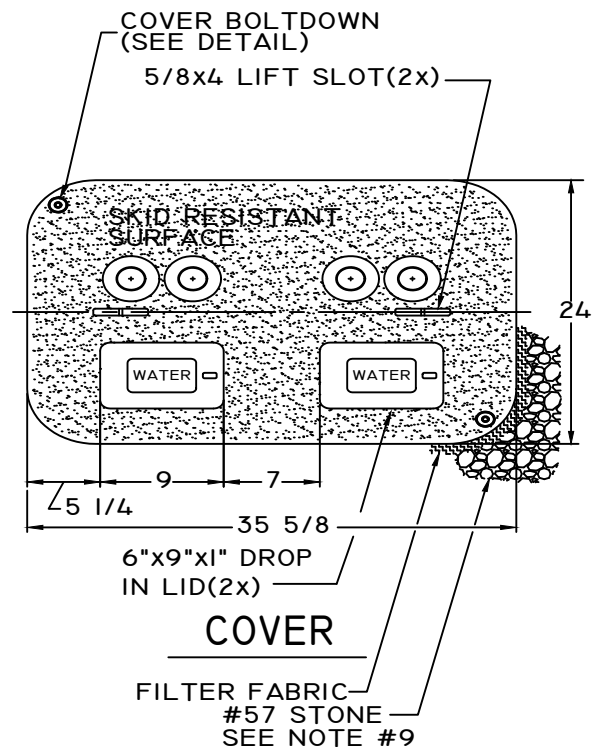

COVER

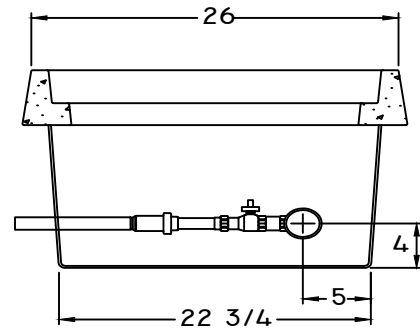

SECTION

NOTES:

1. THIS DETAIL IS INTENDED FOR GROUPS OF 3 TO 4 - $\frac{3}{4}$ " METERS.
2. SEE TYPICAL RESIDENTIAL WATER SERVICE DETAIL TOHO-01 FOR ADDITIONAL REQUIREMENTS
3. CURB STOP SUPPLIED INSIDE THE VAULT SHALL BE PLACED ON THE DOWNSTREAM SIDE OF THE INTERIOR MANIFOLD
4. CONTRACTOR SHALL BE RESPONSIBLE FOR ENSURING METER VAULTS ARE PROPERLY ORIENTED PER THE TOHO APPROVED DRAWINGS AND DETAILS
5. VAULT SHALL BE SET TO SOD GRADE
6. ALL PIPE AND FITTINGS INSIDE THE VAULT SHALL BE NO LEAD BRASS
7. METER VAULTS MUST BE ORDERED WITH THE APPROPRIATE METER SIZE(S) SPECIFIED. NO ALTERATIONS TO THE INTERIOR MANIFOLD ARE PERMITTED AFTER DELIVERY
8. CURB STOP ON 2" WATER SERVICE SHALL BE INSTALLED WITH THE OPERATING NUT FACING UP
9. PLACE #57 STONE A MINIMUM OF 6" DEEP EXTENDING 1' BEYOND ALL EDGES OF THE VAULT. PLACE FILTER FABRIC UNDER THE VAULT ABOVE THE #57 STONE EXTENDING 1' BEYOND ALL EDGES.
10. PLACE APPROVED 3M MARKER TAPE TO THE CURB STOP AND TIED INTO THE TAPE AT THE MAIN