

TOP VIEW

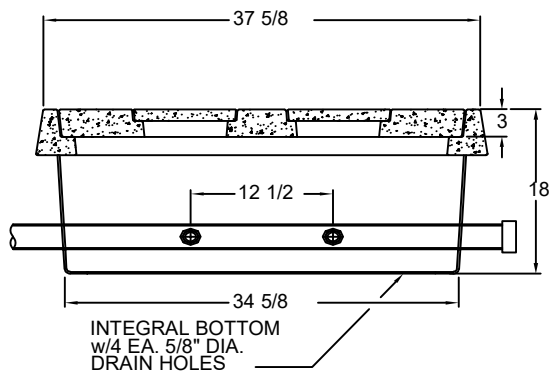

SECTION

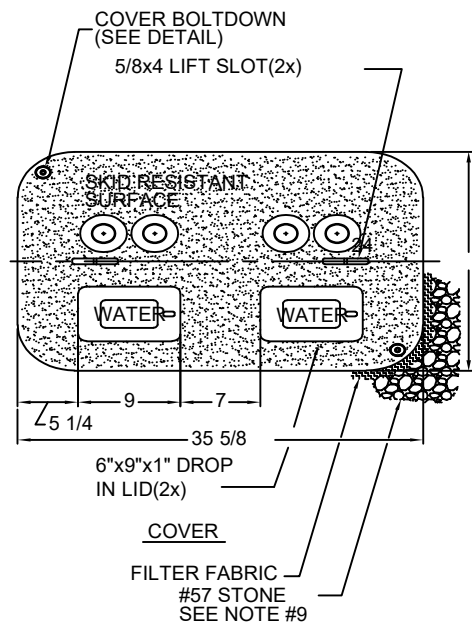

COVER

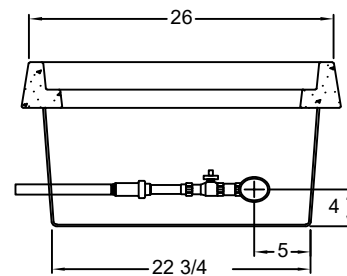

SECTION

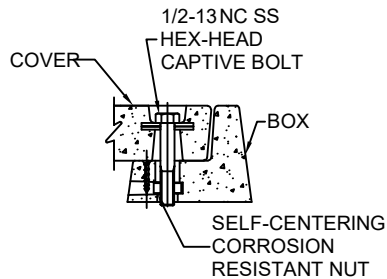

COVER BOLTDOWN DETAIL

NOTES:

1. VAULT AND METER LIDS SHALL BE MADE OF FIBERGLASS REINFORCED POLYMER CONCRETE
2. THIS DETAIL IS INTENDED FOR GROUPS OF 3 TO 4 - 3/4" METERS.
3. SEE TYPICAL RESIDENTIAL WATER SERVICE DETAIL TOHO-01 FOR ADDITIONAL REQUIREMENTS.
4. 2" SERVICE LINE SHALL BE PER COMMERCIAL WATER SERVICE DETAIL TOHO-02.
5. CURB STOP SUPPLIED INSIDE THE VAULT SHALL BE PLACED ON THE DOWNSTREAM SIDE OF THE INTERIOR MANIFOLD.
6. CONTRACTOR SHALL BE RESPONSIBLE FOR ENSURING METER VAULTS ARE PROPERLY CONSTRUCTED AND ORIENTED PER THE TOHO APPROVED DRAWINGS AND DETAILS.
7. TOP OF VAULT SHALL BE SET TO SOD GRADE.
8. ALL PIPE AND FITTINGS INSIDE THE VAULT SHALL BE NO LEAD BRASS.
9. METER VAULTS MUST BE ORDERED WITH THE APPROPRIATE METER SIZE(S) SPECIFIED. NO ALTERATIONS TO THE INTERIOR MANIFOLD ARE PERMITTED AFTER DELIVERY.
10. CURB STOP ON 2" WATER SERVICE SHALL BE INSTALLED WITH THE OPERATING NUT FACING UP.
11. PLACE #57 STONE A MINIMUM OF 6" DEEP EXTENDING 1' BEYOND ALL EDGES OF THE VAULT. PLACE FILTER FABRIC UNDER THE VAULT ABOVE THE #57 STONE EXTENDING 1' BEYOND ALL EDGES.
12. PLACE APPROVED 3M MARKER TAPE TO THE CURB STOP AND TIED INTO THE TAPE AT THE MAIN.



EFFECTIVE DATE:	04/01/2025
BOARD APPROVED DATE:	01/22/2025
PREVIOUS VERSION:	2022
DRAWN BY:	CDR
REVISED BY:	DT

3 - 4 METER VAULT

DRAWING NUMBER

03.0